

<b>Model</b>	F5 LCT (Ricoh RT32, NRG T251)	<b>Volt/Hz</b>	<b>Date of Modification</b>	<b>Serial Number</b>
<b>Modified Article</b>	Cushion - Motor	A459 - 17		
<b>Reason for Modification</b>	To standardize with other models			
		A459 - 22		

To standardize with other models, the part number of the following part has been modified.

Old P/N	New P/N	Description	Q'ty Used	Inter-change-ability	Parts Catalog	
					Index No.	Page
AA161014	AA161104	Cushion - Motor	4 → 4	O/O	26	13

  
T. Inoue, General Manager  
1st Field Information Dept. QAC

<b>Model</b>		F5 LCT (Ricoh RT32, NRG T251)					<b>Code</b>	<b>Model Name</b>	<b>Serial Number</b>	
<b>Modified Article</b>		Upper Cover, etc.					A459 - 17	RT32	A355100001	
<b>Reason for Modification</b>		To comply with the CE mark standards (For A459-22, -27) To standardize the parts (For A459-17)					A459 - 27	RT32	A355080001	
							A459 - 22	T251	621508XXXX	
Draw No.	Old Parts No.	New Parts No.	Description	Rank	Q'ty Used Old→New	Inter-change-ability	Parts needed for replacement by new part		Parts Catalog	
							Part No.	Description	No.	Page
<b>Information for the Ricoh European version model (A459 - 27) starts from this bulletin. MB No. 1 is for the other versions (A459 - 17, A459 - 22) only.</b>										
1	A4591206	A4591208	Upper Cover		1 → 1	X/O	(O/O for the U. S. A. version.)		3	5
1	A4591320	A4591323	Hinge Bracket Cover		1 → 1	X/O	(O/O for the U. S. A. version.)		16	5
1	A4591310	A4591313	Hinge Bracket		1 → 1	X/O	(O/O for the U. S. A. version.)		17	5
1	03140060W	03140060B	Philips Pan Head Screw - M4 x 6		n → n-3				101	5
			Philips Pan Head Screw - M4 x 6		0 → 4	X/O	(O/O for the U. S. A. version.)		*122	5
1		68025703	Grounding Wire		1 → 3				44	5
									* : New Index	

Rank: A : Replace with new parts immediately. B : Replace with new parts at time of repair. C : Replace with new parts at time of overhaul.

Interchangeability:

- (1) When old and new parts are not mutually interchangeable, use additional parts or an assembly part as indicated in "Parts needed for replacement by new part" to install the new part.
- (2) The mark to the left of the slash indicates whether the old part can be used in the new machine, and the mark to the right indicates whether the new part can be used in the old machine. x = Not interchangeable o = Interchangeable



**DETAILS OF MODIFICATION**

To comply with the CE mark standards, the parts described on the previous pages have been changed.  
 For the U. S. A. version units (A459-17), some parts have been changed as described for the parts standardization.

NOTE: All new parts are for the new type machines only and are not needed for the old machines.

**Drawing No. 1**

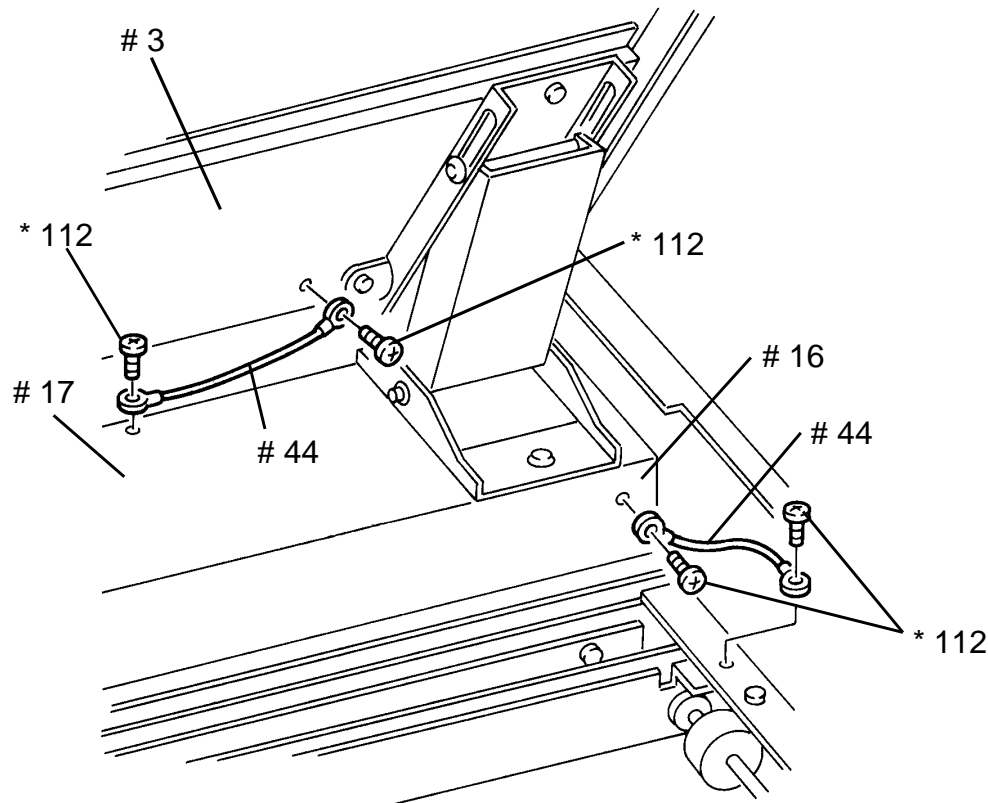

DETAILS OF MODIFICATION

Drawing No. 2

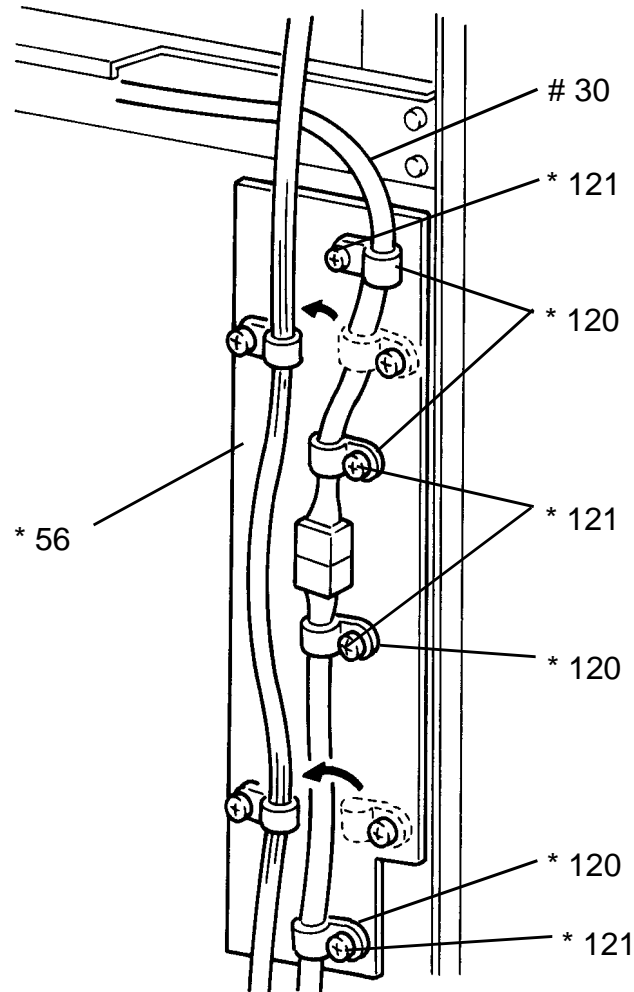

M. Iwasa, Manager  
Technical Support Department

<b>Model</b>	F5 LCT(Ricoh RT32, NRG T251)	<b>Volt/Hz</b>	<b>Date of Modification</b>	<b>Serial Number</b>
<b>Modified Article</b>	Pulley - 24Z	A459-17	RT32	A3555100001
<b>Reason for Modification</b>	To prevent the timing belt from slipping (running) off the pulley	A459-27	RT32	A3555090001
		A459-22	T251	621603XXXX

To prevent the timing belt from slipping off the pulley, the pulley has been changed so that there are flanges at both ends.

Old P/N	New P/N	Description	Q'ty Used	Inter-changeability	Parts Catalog	
					Index No.	Page
A4591551	A4591553	Pulley - 24Z	2 → 2	X/O	41	5

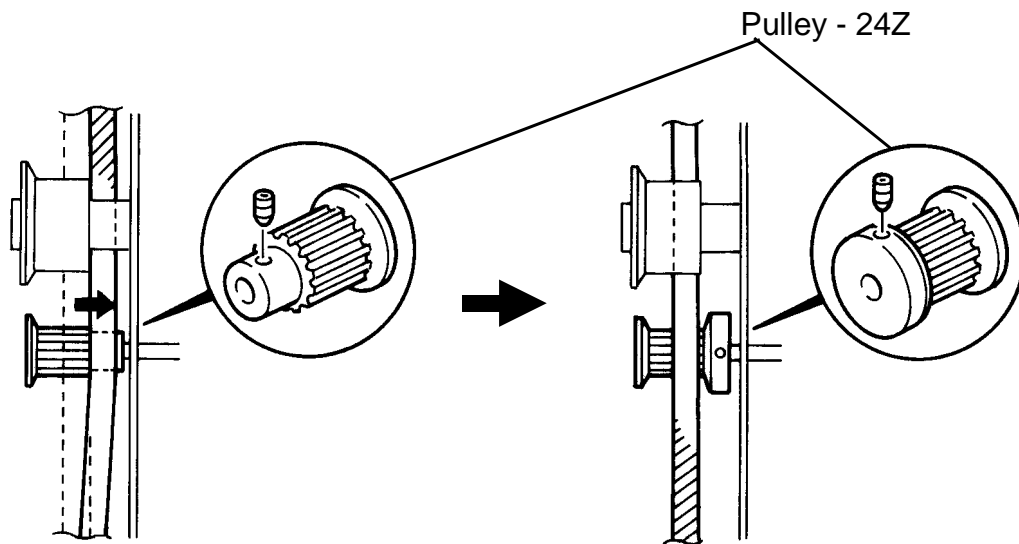

*T. Inoue*  
 T. Inoue, General Manager  
 1st Field Information Dept. QAC

Model	F5 LCT(Ricoh RT32, NRG T251)	Volt/Hz		Date of Modification		Serial Number	
Modified Article	Cushion - 7 x 9 x 20	A459-17		RT32		A3555100001	
Reason for Modification	To prevent the transport driven roller shaft from being scraped.	A459-27		RT32		A3555120013	
		A459-22		T251		621603XXXX	

New P/N	Description	Q'ty Used	Parts Catalog	
			Index No.	Page
AA162075	Cushion - 7 x 9 x 20	0 → 1	* 44	15

\* New Index

When the lock lever is bent, the transport driven roller shaft is scraped by the center guide plate. To prevent this, the lock lever has been strengthened (A) and a cushion has been added. The part number of the lock lever has not changed.

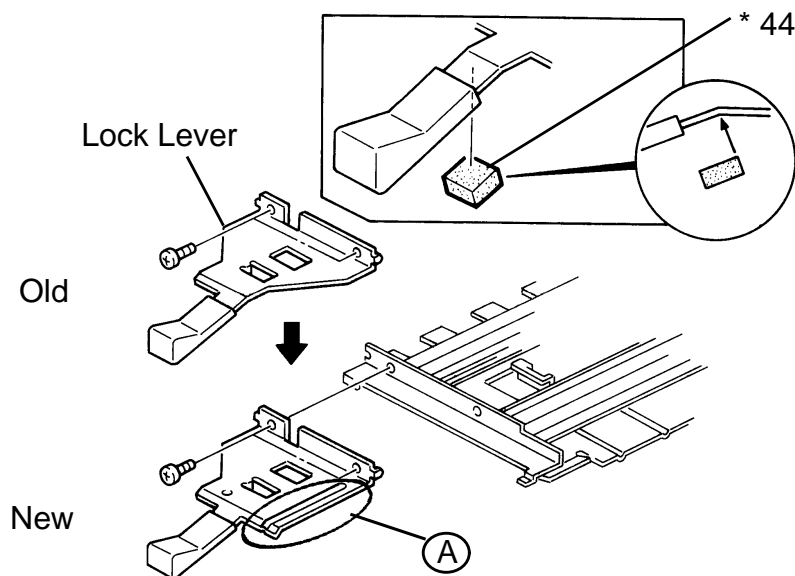

*T. Inoue*  
 T. Inoue, General Manager  
 1st Field Information Dept. QAC

<b>Model</b>	F5 LCT (Ricoh RT32, NRG T251)	<b>Volt/Hz</b>	<b>Date of Modification</b>	<b>Serial Number</b>
<b>Modified Article</b>	Rear Side Plate - Transport / Transfer Drive Motor Bracket	A459-17	RT32	A3555100001
<b>Reason for Modification</b>	To facilitate assembly	A459-27	RT32	A3555090001
		A459-22	T251	621603XXXX

Old P/N	New P/N	Description	Q'ty Used	Inter-change-ability	Parts Catalog	
					Index No.	Page
A4591515	A4591527	Rear Side Plate - Transport	1 → 1	X/O	33	5
A4591559	A4591568	Transfer Drive Motor Bracket	1 → 1	X/O	75	5

To facilitate assembling, the following parts have been modified.

1. Rear Side Plate - Transport  
A hole (A) (φ10) has been added as shown to prevent it from coming in contact with screw (B).
2. Transfer Drive Motor Bracket  
A cover (C) of the motor bracket has been cut off to prevent it from touching against the transport left stay.

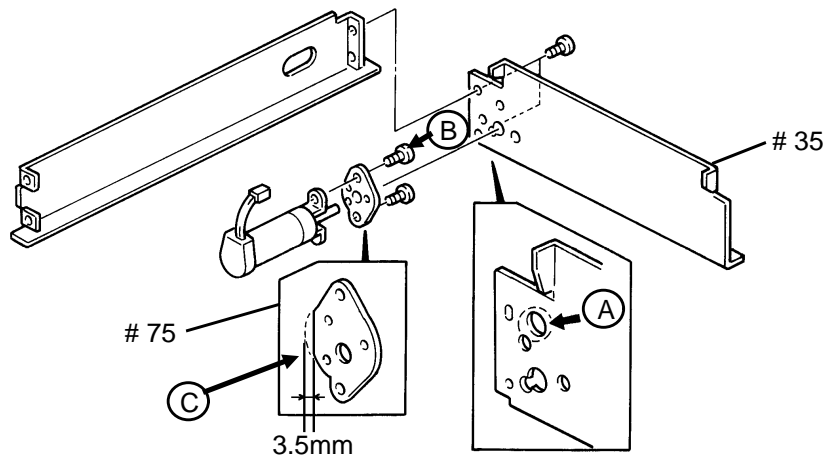

*T. Inoue*  
 T. Inoue, General Manager  
 1st Field Information Dept. QAC



<b>Model</b>	F5 LCT (Ricoh RT32, NRG T251) (NRG only)	<b>Volt/Hz</b>	<b>Date of Modification</b>	<b>Serial Number</b>
<b>Modified Article</b>	Front Lower Cover	A459-17	RT32	
<b>Reason for Modification</b>	To meet UL standardization	A459-27	RT32	
		A459-22	T251	6213100001

Old P/N	New P/N	Description	Q'ty Used	Inter-changeability	Parts Catalog	
					Index No.	Page
A4591266	A4591268	Front Lower Cover	1 → 1	X/O	24	5
	A4591270	Blind Cover	0 → 1		* 76	5
	03140060W	Philips Pan Head Screw - M4 x 6	n → n+2		101	5

To meet UL standardization, the blind cover has been added as shown.  
 This cover prevents a customer from coming in contact with the electrical parts.

\* New Index

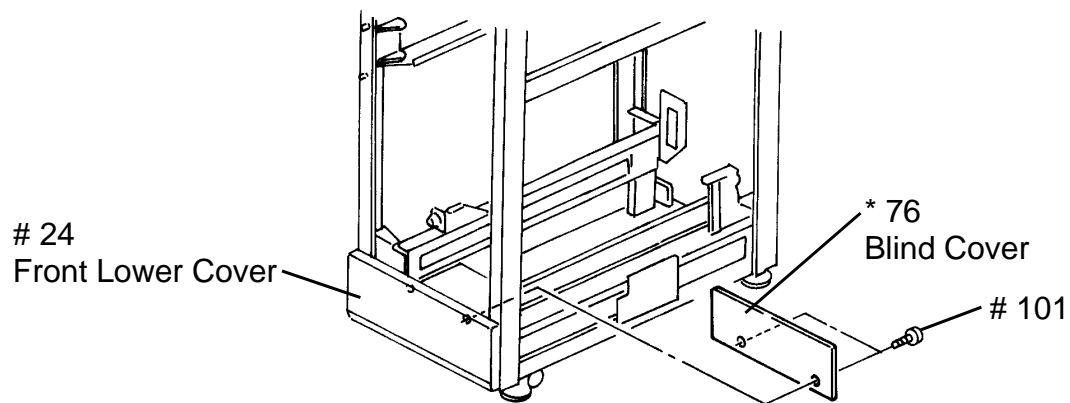

*T. Inoue*  
 T. Inoue, General Manager  
 1st Field Information Dept. QAC

<b>Model</b>	F5 LCT (Ricoh RT32, NRG T251)	<b>Volt/Hz</b>	<b>Date of Modification</b>	<b>Serial Number</b>
<b>Modified Article</b>	Diode and Capacitor			
<b>Reason for Modification</b>	Due to a vendor change			

Old P/N	New P/N	Description	Q'ty Used	Inter-change-ability	Parts Catalog	
					Index No.	Page
14010615	14020959	Diode - 1S1586	2 → 0		19	119
		Silicon Diode - 1S2076A	0 → 2	O/O	19	119
16061448	16062081	Capacitor - 0.1μF ±10% 63V	2 → 2	O/O	19	166

Due to a vendor change, a diode and a capacitor have been changed with the interchangeability O/O.



T. Inoue, General Manager  
1st Field Information Dept. QAC